

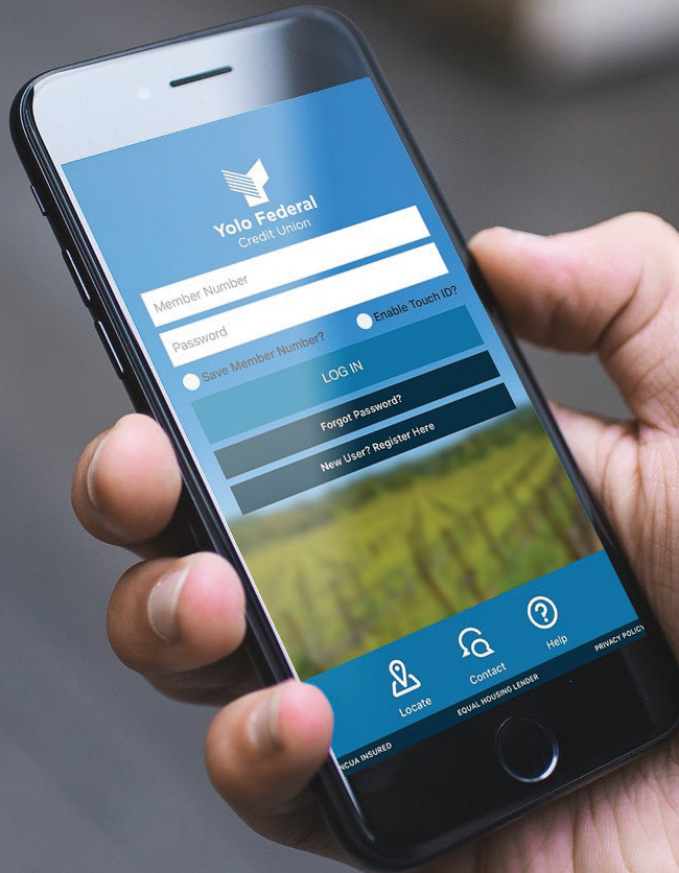

Yolo Federal
Credit Union



USER GUIDE
Manage Cards

Manage Cards

Turn your cards on and off with just a click. To use this tool, click on Manage Cards from the menu. To disable a card, click directly on the card.

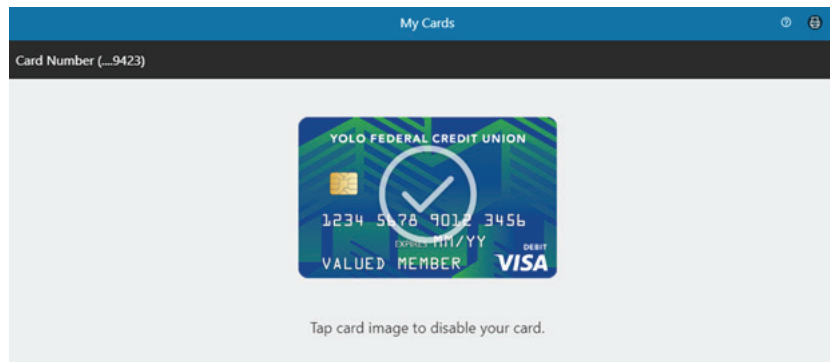

A window will pop up to confirm your selection. Select the blue Disable Button to confirm.

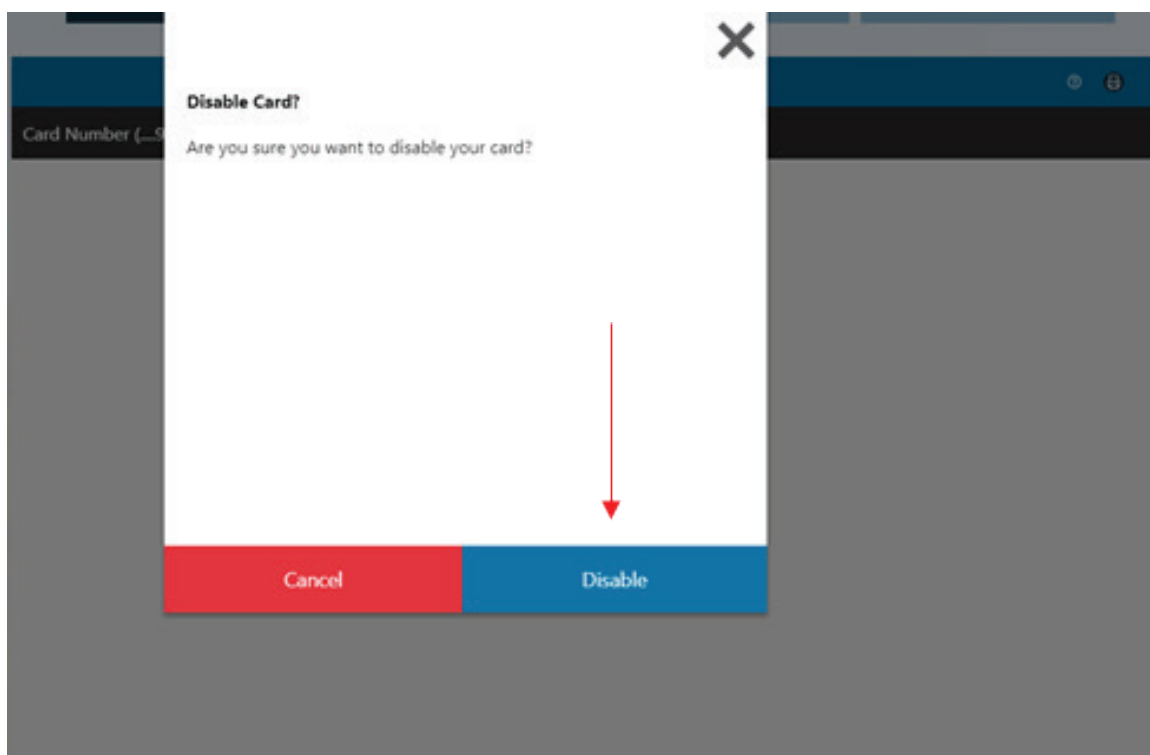

To reactivate a disabled card, click directly on the card again. Note: All disabled cards will appear black with stripes to indicate that it is disabled.

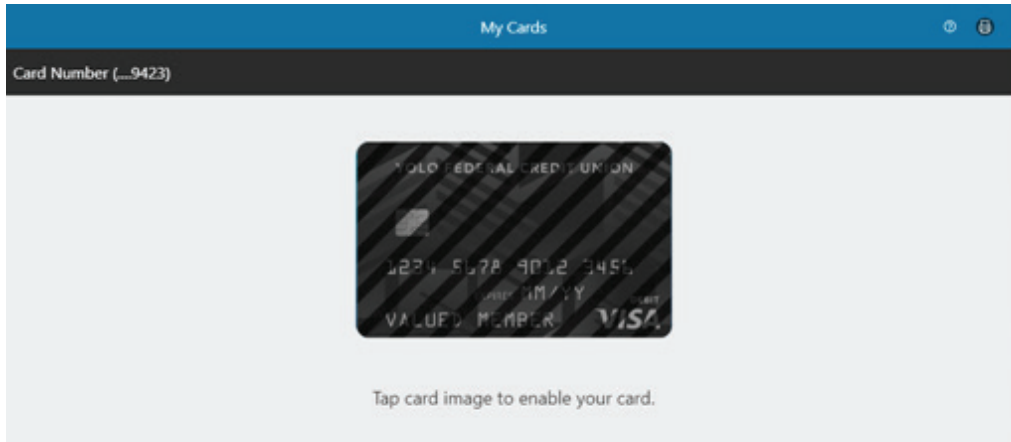

A window will pop up to confirm you wish to reactivate the card. Select the blue Enable button to confirm.

